

**\*\*\* GENERAL CONSTRUCTION \*\*\***

**MODIFIED ISO CONTAINER**  
**3mm FLOOR PLATES OVER TIMBER FLOORS**  
**100mm MINERAL WOOL TREATMENT ENGINE**  
**COMPARTMENT AND 50mm UPS**  
**0.7mm PERF AND 1.2mm INNER SKIN ZINTEC**  
**TRAYS**

**EXTERNAL WALL & ROOF COLOUR: BLACK**  
**INTERNAL WALL & ROOF COLOUR: WHITE**  
**FLOOR INTERNAL COLOUR: BLACK NON SLIP.**  
**FLOOR UNDERSIDE COLOUR: BLACK**  
**UNDERSEAL.**  
**NOISE LEVEL 85db(A) @ 1mtr**  
**8HR DAY TANK AT 75% LOAD**

**INNER FACE OF END**  
**DOORS TO BE PACKED**  
**WITH MINERAL WOOL**  
**BETWEEN**  
**CORUGATIONS AND**  
**RETAINED WITH**  
**MELINEX & PERF.**

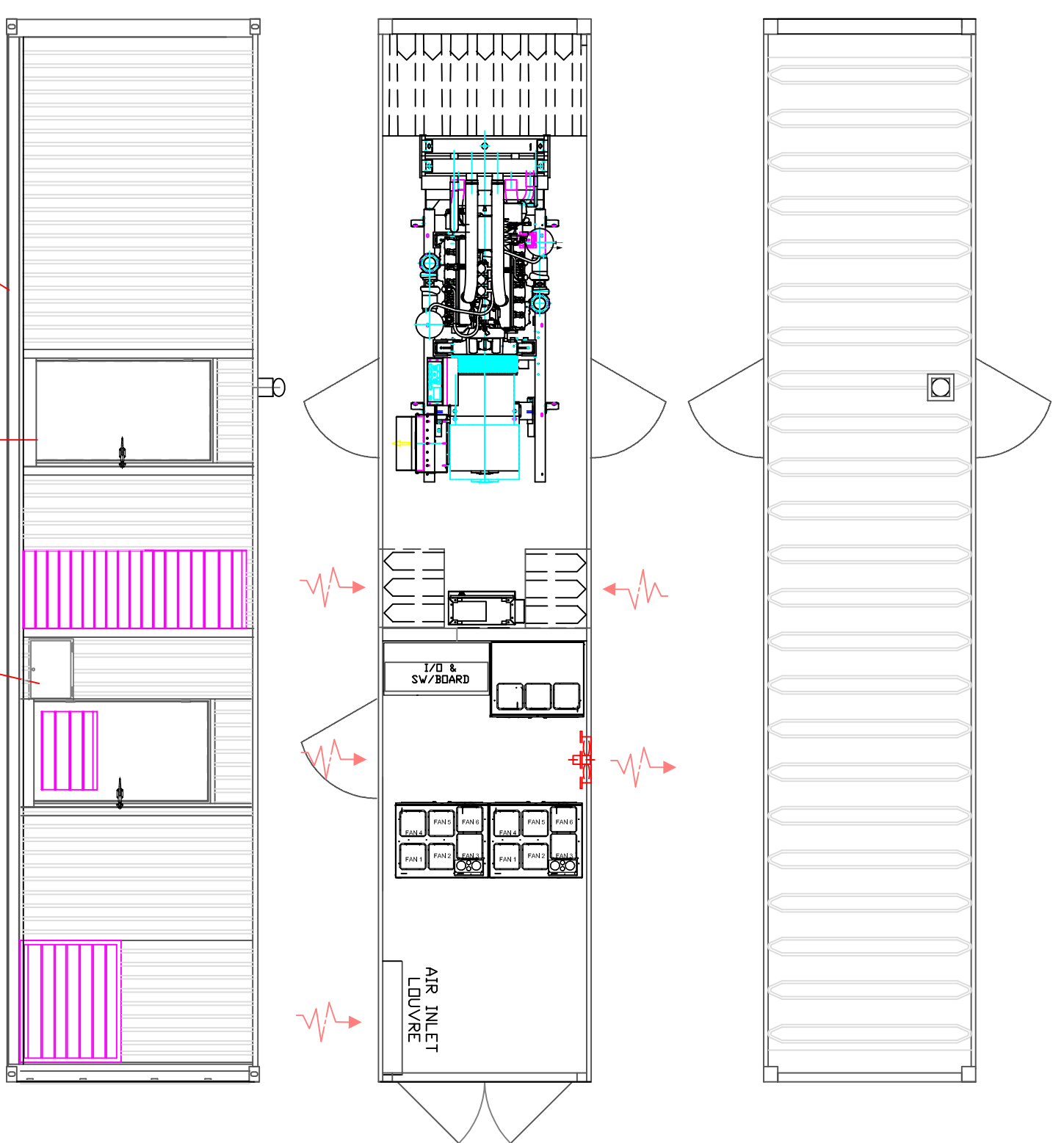

**EXHAUST OUTLET C/W RAIN CAP**  
**EXIT TO SUIT SILENCER &**  
**REMOVABLE FOR SHIPPING.**

**STRENGTHENING**  
**STRIP UNDER**  
**CONTAINER SIDE**  
**CHANNELS AND**  
**BUNDED ENGINE**  
**ROOM FLOOR**

**DOOR & FRAME SET C/W SLAM**  
**FASTENER WITH INTERNAL PANIC**  
**RELEASE & CHECK STRAP BOLTED**  
**INTO RHS APERTURE.**

**INPUT/OUTPUT**  
**CABLING**  
**CONNECTION**  
**POINT**

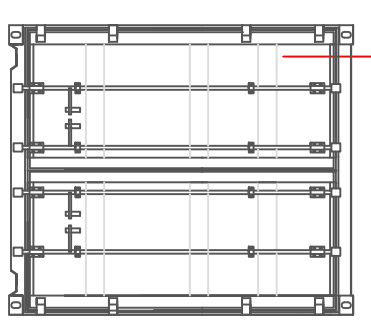

**THIS IS NOT A DESIGN DRAWING AND IS ISSUED FOR INFORMATION ONLY.**

<small>THIS DRAWING IS THE PROPERTY OF ACTIVE POWER. IT IS TO BE USED ONLY FOR THE PROJECT AND NOT TO BE REPRODUCED OR TRANSMITTED IN ANY FORM OR BY ANY MEANS, ELECTRONIC OR MECHANICAL, INCLUDING PHOTOCOPYING, RECORDING, OR BY ANY INFORMATION STORAGE AND RETRIEVAL SYSTEM. WITHOUT THE WRITTEN PERMISSION OF ACTIVE POWER.</small>				
	PROJECT NO: AP308999-014 DRAWING NO: 2/4			
<b>Item#</b>   <b>Quantity</b>   <b>Title/Name, designation, material, dimension etc</b>   <b>Article No./Reference</b>	<b>Drawn By</b>   <b>Checked by</b>   <b>Approved By - date</b>   <b>Date</b>   <b>Scale</b>			
KB	ML	U-SH	28.08.08	1:1
<b>ACTIVE POWER</b>		<b>400KW POWERHOUSE</b>	Edition B	Sheet 2/4